

CAGE CLAMP®

224 Series CAGE CLAMP®

Lighting connectors for junction boxes

Quick, simple and easy to use

The WAGO 224 Series lighting connector allows fast wiring for solid to fine-stranded conductors safely due to the spring connection.

- CAGE CLAMP® connection, Re-usable
- 0.5 – 2.5mm², 24A rating
- Continuous service temperature 105°C
- Ideal connection between solid and fine-stranded conductors
- International approvals

Suitable applications:-

- Lighting

For a complete package

WAGOBOX Light enclosure is designed for use with the 224 Series connectors.

- Fast
- Easy to use
- Compact
- Professional

Part No. 51257303

WAGO®
INNOVATIVE CONNECTIONS

224 Series technical data

Installation side 1 – 2.5mm² "s"
 Lighting side 0.5 – 2.5mm² "s + f-st + st" ^①
 400 V/4 kV/2 ^②
 24A
 9 - 11mm

- ① Both sides of the 224-201 connector allows for 0.5 – 2.5mm² "s + f-st"
 ② In grounded (earthed) supply systems

Dimensions (mm)

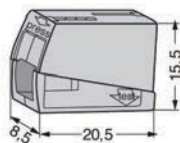

224-101
2-conductor

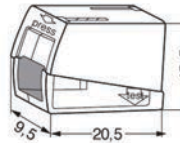

224-112
3-conductor

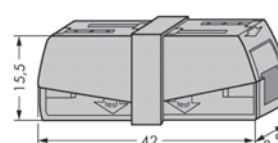

224-201
2-conductor ^①

Installation side - PUSH WIRE® clamps the following copper conductors



solid only

Lighting side - CAGE CLAMP® clamps the following copper conductors



solid



stranded



fine-stranded



ferruled ^③



tip-bonded

Operating

^③ With ferruled conductors, the max. conductor cross-section accommodated is one size smaller than max. rating of the connector.

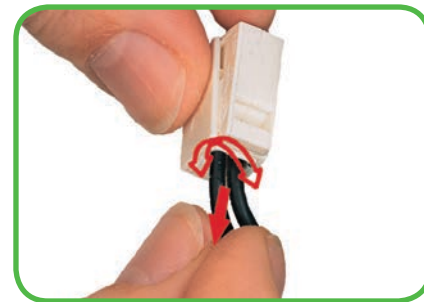
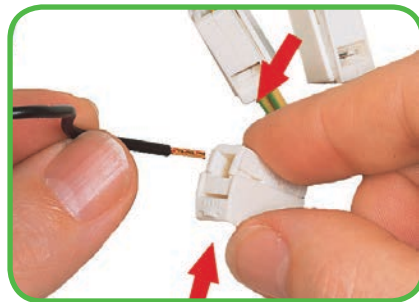

1. Strip both conductors 9 – 11mm.
2. Insert the solid conductor fully into the installation side to complete the connection.

3. To connect the lighting side squeeze together the housing and insert the conductor fully, then release to complete the connection.

4. To remove the installation side simply twist and pull the conductor at the same time. To remove the lighting side squeeze together the housing and pull the conductor.

High temperature

The 224 Series standard connectors have a continuous service temperature of 105 °C. If a higher temperature rating is required, our 224-104 & 224-114 are rated up to 120°C continuous service.



224-104
2-conductor



224-114
3-conductor



Easy testing

The test point is on the bottom of the housing.